

MATTA FAIR 2024

HALL 2 - HALL 4, LEVEL 1 (GROUND FLOOR)

MALAYSIA INTERNATIONAL TRADE & EXHIBITION CENTRE (MITEC)

6th - 8th SEPTEMBER 2024



QUBE Integrated Malaysia Sdn. Bhd.
 Wisma Qube, No 32-3, Jalan Nautika B U20/B, Seksyen U20, TSB Commercial Centre, Sg. Buloh, 40160, Shah Alam, Selangor Darul Ehsan, Malaysia
 Tel : +603 6151 9973 / 9673 / 9873
 Fax : +603 6151 3973 / 3673
 http://www.qube.com.my

JOB NO.
B 015/005/24

PROJECT TITLE
MATTA FAIR 2024

SHOW PERIOD
6th - 8th SEPTEMBER 2024

VENUE / ADDRESS
MALAYSIA INTERNATIONAL TRADE & EXHIBITION CENTRE (MITEC)

CITY / COUNTRY
KUALA LUMPUR, MALAYSIA

CLIENT
MATTA

CLIENT APPROVAL DATE

DRAWING TITLE SCALE
HALL 2 - HALL 4 A3 1 : 700
LAYOUT PLAN A4 1 : 1000

PERSON-IN-CHARGE
MONG

DRAWN BY DATE
ARI 05042024

CHECKED BY DATE
YK 05042024

DRAWING NO.	REVISION
DWG 001	R16 06082024 ARI
	R15 31072024 ARI
	R14 25072024 ARI
	R13 18072024 ARI

REMARKS

OFFICE USED :-
CHECKLIST

OFFSITE	DESCRIPTION	ON SITE
	Dimension	
	Colour used	
	Material used	
	Graphic size	
	Others	

NOTE (offsite) NOTE (onsite)

CHECKED BY (offsite) CHECKED BY (onsite)

DATE DATE

A COPYRIGHT :-
 This design may not be reproduced in part or whole without prior written permission of Qube Integrated Malaysia Sdn. Bhd.
 This drawing is subject to modification to suit construction purposes.

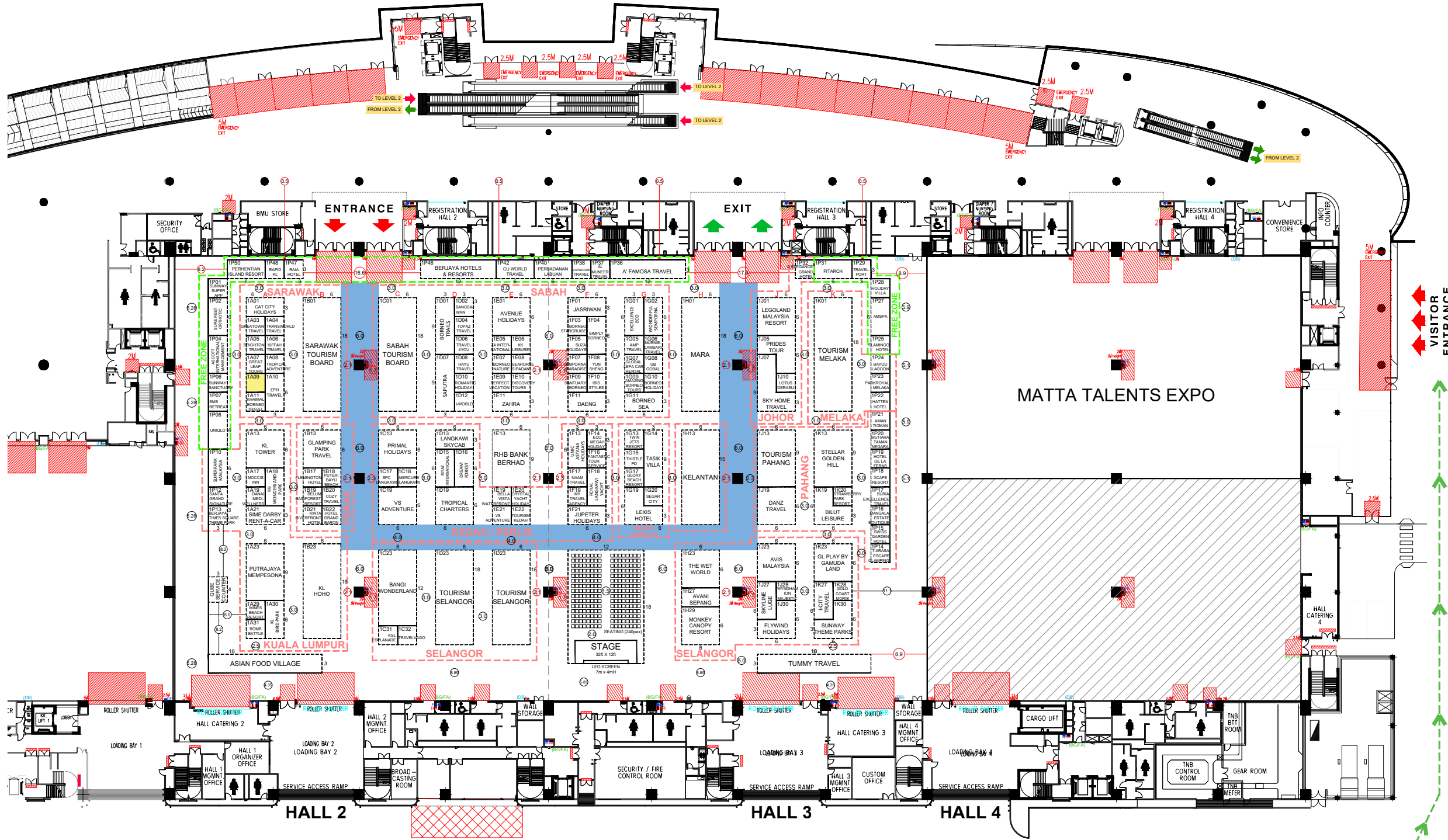

VENUE LEGEND

CODE	DESCRIPTION	CODE	DESCRIPTION
HR	HOSE REEL		NON BUILD AREA
BG/FA	BREAKING GLASS & FIRE ALARM		PILLAR 1650mm x 1650mm
FE	FIRE EXTINGUISHER	HR	FIRE HOSE REEL 600mm x 1000mm
DB	DB BOX		

MAXIMUM LOADING 50k/h
 MAXIMUM CEILING HEIGHT 8m

@ Reserved
 Number Title : SYSF435 - 04

HIGHWAY AREA
 Total of 350 nos. 3m X 3m

** HALL PLAN UPDATE AS 29022024 ARI

Date : 070808
 Revision : 0

MATTA FAIR 2024

HALL 6 - HALL 8, LEVEL 2 (MIDDLE FLOOR)

MALAYSIA INTERNATIONAL TRADE & EXHIBITION CENTRE (MITEC)

6th - 8th SEPTEMBER 2024



QUBE Integrated Malaysia Sdn. Bhd.
 Wisma Qube, No 32-3, Jalan Nautika B U20/B, Seksyen U20, TSB Commercial Centre, Sg. Buloh, 40160, Shah Alam, Selangor Darul Ehsan, Malaysia
 Tel : +603 6151 9973 / 9673 / 9873
 Fax : +603 6151 3973 / 3673
 http://www.qube.com.my

JOB NO.
B 0 1 5 / 0 0 5 / 2 4

PROJECT TITLE
MATTA FAIR 2024

SHOW PERIOD
6th - 8th SEPTEMBER 2024

VENUE / ADDRESS
MALAYSIA INTERNATIONAL TRADE & EXHIBITION CENTRE (MITEC)

CITY / COUNTRY
KUALA LUMPUR, MALAYSIA

CLIENT
MATTA

CLIENT APPROVAL DATE

DRAWING TITLE SCALE
HALL 6 - HALL 8 A3 1 : 700
LAYOUT PLAN A4 1 : 1000

PERSON-IN-CHARGE
MONG

DRAWN BY DATE
ARI 05042024

CHECKED BY DATE
YK 05042024

DRAWING NO.	REVISION
DWG 002	R16 06082024 ARI
	R15 31072024 ARI
	R14 25072024 ARI
	R13 18072024 ARI

REMARKS

OFFICE USED :-
CHECKLIST

OFFSITE	DESCRIPTION	ON SITE
	Dimension	
	Colour used	
	Material used	
	Graphic size	
	Others	

NOTE (offsite) NOTE (onsite)

CHECKED BY (offsite) CHECKED BY (onsite)

DATE DATE

A COPYRIGHT :-
 This design may not be reproduced in part or whole without prior written permission of Qube Integrated Malaysia Sdn. Bhd.
 This drawing is subject to modification to suit construction purposes.

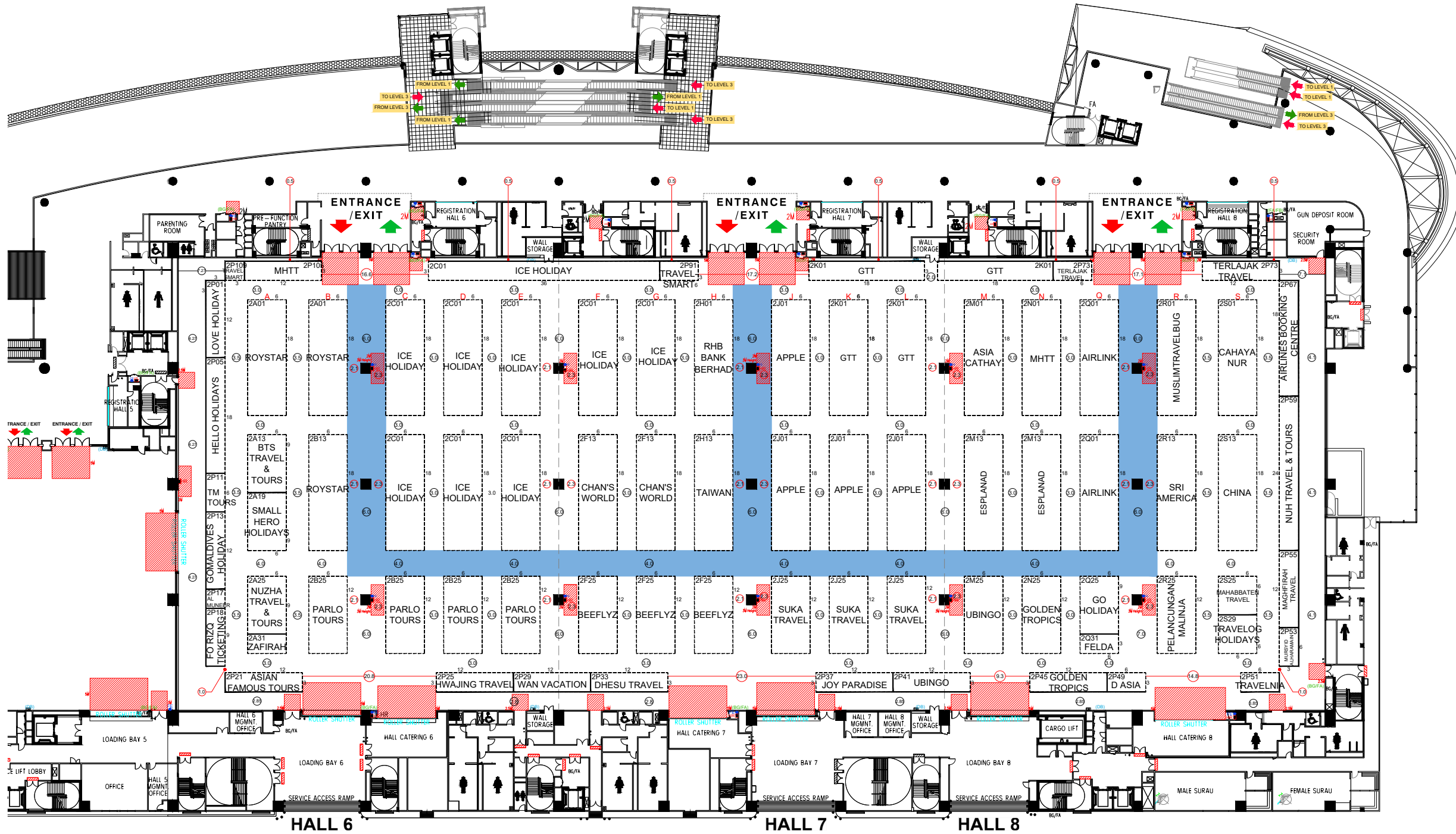

VENUE LEGEND

CODE	DESCRIPTION	CODE	DESCRIPTION
HR	HOSE REEL		NON BUILD AREA
BG/FA	BREAKING GLASS & FIRE ALARM		PILLAR 1650mm x 1650mm
FE	FIRE EXTINGUISHER	HR	FIRE HOSE REEL 600mm x 1000mm
DB	DB BOX		

MAXIMUM LOADING 50k/h
 MAXIMUM CEILING HEIGHT 8m

@ Reserved
 Number Title : SYSF435 - 04

HIGHWAY AREA
 Total of **621** nos. 3m X 3m

** HALL PLAN UPDATE AS 29022024 ARI

Date : 070808
 Revision : 0

MATTA FAIR 2024

HALL 9 - HALL 11, LEVEL 3 (TOP FLOOR)

MALAYSIA INTERNATIONAL TRADE & EXHIBITION CENTRE (MITEC)

6th - 8th SEPTEMBER 2024



QUBE Integrated Malaysia Sdn. Bhd.
 Wisma Qube, No 32-3, Jalan Nautika B U20/B, Seksyen U20, TSB Commercial Centre, Sg. Buloh, 40160, Shah Alam, Selangor Darul Ehsan, Malaysia
 Tel : +603 6151 9973 / 9673 / 9873
 Fax : +603 6151 3973 / 3673
 http://www.qube.com.my

JOB NO.
B 015/005/24

PROJECT TITLE
MATTA FAIR 2024

SHOW PERIOD
6th - 8th SEPTEMBER 2024

VENUE / ADDRESS
MALAYSIA INTERNATIONAL TRADE & EXHIBITION CENTRE (MITEC)

CITY / COUNTRY
KUALA LUMPUR, MALAYSIA

CLIENT
MATTA

CLIENT APPROVAL DATE

DRAWING TITLE SCALE
HALL 9 - HALL 11 A3 1 : 700
LAYOUT PLAN A4 1 : 1000

PERSON-IN-CHARGE
MONG

DRAWN BY DATE
ARI 05042024

CHECKED BY DATE
YK 05042024

DRAWING NO.	REVISION
DWG 003	R16 06082024 ARI
	R15 31072024 ARI
	R14 25072024 ARI
	R13 18072024 ARI

REMARKS

OFFICE USED :-
CHECKLIST

OFFSITE	DESCRIPTION	ON SITE
	Dimension	
	Colour used	
	Material used	
	Graphic used	
	Others	

NOTE (offsite) NOTE (onsite)

CHECKED BY (offsite) CHECKED BY (onsite)

DATE DATE

A COPYRIGHT :-
 This design may not be reproduced in part or whole without prior written permission of Qube Integrated Malaysia Sdn. Bhd.
 This drawing is subject to modification to suit construction purposes.

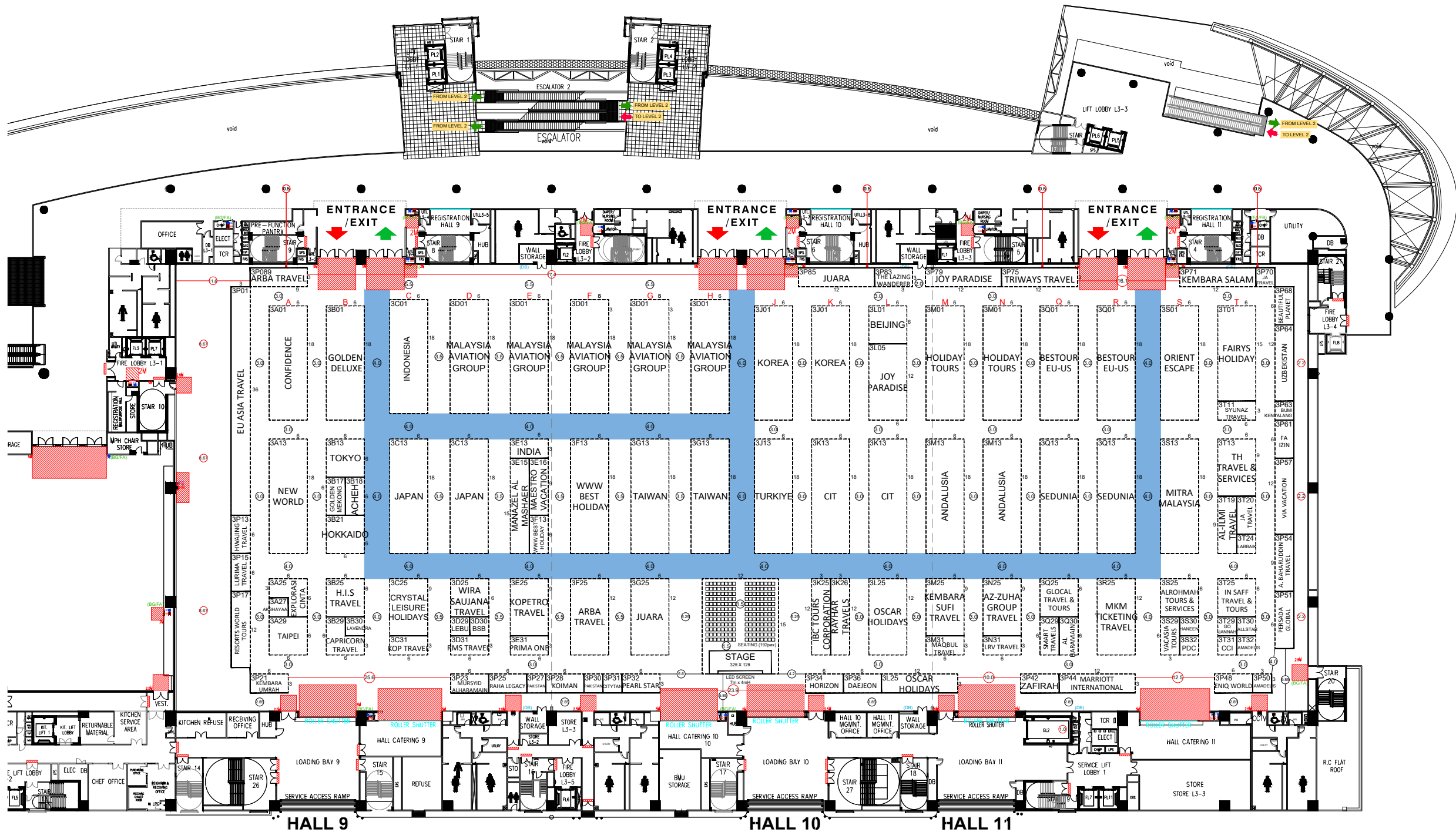

VENUE LEGEND

CODE	DESCRIPTION	CODE	DESCRIPTION
HR	HOSE REEL		NON BUILD AREA
BG/FA	BREAKING GLASS & FIRE ALARM		PILLAR 1650mm x 1650mm
FE	FIRE EXTINGUISHER	HR	FIRE HOSE REEL 600mm x 1000mm
DB	DB BOX		

MAXIMUM LOADING 50k/h
 MAXIMUM CEILING HEIGHT 8m

@ Reserved
 Number Title : SYSF435 - 04

HIGHWAY AREA
 Total of 619 nos. 3m X 3m

** HALL PLAN UPDATE AS 29022024 ARI

Date : 070808
 Revision : 0