

MATTA FAIR 2025

HALL 2 - HALL 4, LEVEL 1 (GROUND FLOOR)

MALAYSIA INTERNATIONAL TRADE & EXHIBITION CENTRE (MITEC)

18th - 20th APRIL 2025



QUBE Integrated Malaysia Sdn. Bhd.
 A-13-11, MENARA THE MET,
 NO. 20, JALAN DUTAMAS 2,
 50480 KUALA LUMPUR, MALAYSIA
 Tel : +603-6211 9973
 http://www.qube.com.my

JOB NO.
 B017/001/25

PROJECT TITLE
 MATTA FAIR 2025

SHOW PERIOD
 18th - 20th APRIL 2025

VENUE / ADDRESS
 MALAYSIA INTERNATIONAL TRADE & EXHIBITION CENTRE (MITEC)

CITY / COUNTRY
 KUALA LUMPUR, MALAYSIA

CLIENT
 MATTA

CLIENT APPROVAL DATE

DRAWING TITLE SCALE
 HALL 2 - HALL 4 A3 1 : 700
 LAYOUT PLAN A4 1 : 1000

PERSON-IN-CHARGE
 MONG

DRAWN BY DATE
 ARI 27092024

CHECKED BY DATE
 YK 27092024

DRAWING NO.	REVISION
DWG 001	R10 27032025 ARI
	R09 20032025 ARI
	R08 14032025 ARI
	R07 06032025 ARI

REMARKS

OFFICE USED :-
 CHECKLIST

OFFSITE	DESCRIPTION	ON SITE
	Dimension	
	Colour used	
	Material used	
	Graphic size	
	Others	

NOTE (offsite) NOTE (onsite)

CHECKED BY (offsite) CHECKED BY (onsite)

DATE DATE

A COPYRIGHT :-
 This design may not be reproduced in part or whole without prior written permission of Qube Integrated Malaysia Sdn. Bhd. This drawing is subject to modification to suit construction purposes.



VENUE LEGEND

CODE	DESCRIPTION	CODE	DESCRIPTION
HR	HOSE REEL		NON BUILD AREA
BG/FA	BREAKING GLASS & FIRE ALARM		PILLAR 1650mm x 1650mm
FE	FIRE EXTINGUISHER	HR	FIRE HOSE REEL 600mm x 1000mm
DB	DB BOX		

MAXIMUM LOADING 50k/h
 MAXIMUM CEILING HEIGHT 8m

@ Reserved
 Number Title : SYSF435 - 04

SHUTTLE DROP-OFF

Total of 514 nos. 3m X 3m

** HALL PLAN UPDATE AS 29022024 ARI

Date : 070808
 Revision : 0

MATTA FAIR 2025

HALL 6 - HALL 8, LEVEL 2 (MIDDLE FLOOR)

MALAYSIA INTERNATIONAL TRADE & EXHIBITION CENTRE (MITEC)

18th - 20th APRIL 2025



QUBE Integrated Malaysia Sdn. Bhd.
 A-13-11, MENARA THE MET,
 NO. 20, JALAN DUTAMAS 2,
 50480 KUALA LUMPUR, MALAYSIA
 Tel : +603-6211 9973
 http://www.qube.com.my

JOB NO.
 B017/001/25

PROJECT TITLE
 MATTA FAIR 2025

SHOW PERIOD
 18th - 20th APRIL 2025

VENUE / ADDRESS
 MALAYSIA INTERNATIONAL TRADE & EXHIBITION CENTRE (MITEC)

CITY / COUNTRY
 KUALA LUMPUR, MALAYSIA

CLIENT
 MATTA

CLIENT APPROVAL DATE

DRAWING TITLE SCALE
 HALL 6 - HALL 8 A3 1 : 700
 LAYOUT PLAN A4 1 : 1000

PERSON-IN-CHARGE
 MONG

DRAWN BY DATE
 ARI 27092024

CHECKED BY DATE
 YK 27092024

DRAWING NO.	REVISION
DWG 002	R10 27032025 ARI
	R09 20032025 ARI
	R08 14032025 ARI
	R07 06032025 ARI

REMARKS

OFFICE USED :-
 CHECKLIST

OFFSITE	DESCRIPTION	ON SITE
	Dimension	
	Colour used	
	Material used	
	Graphic size	
	Others	

NOTE (offsite) NOTE (onsite)

CHECKED BY (offsite) CHECKED BY (onsite)

DATE DATE

A COPYRIGHT :-
 This design may not be reproduced in part or whole without prior written permission of Qube Integrated Malaysia Sdn. Bhd. This drawing is subject to modification to suit construction purposes.

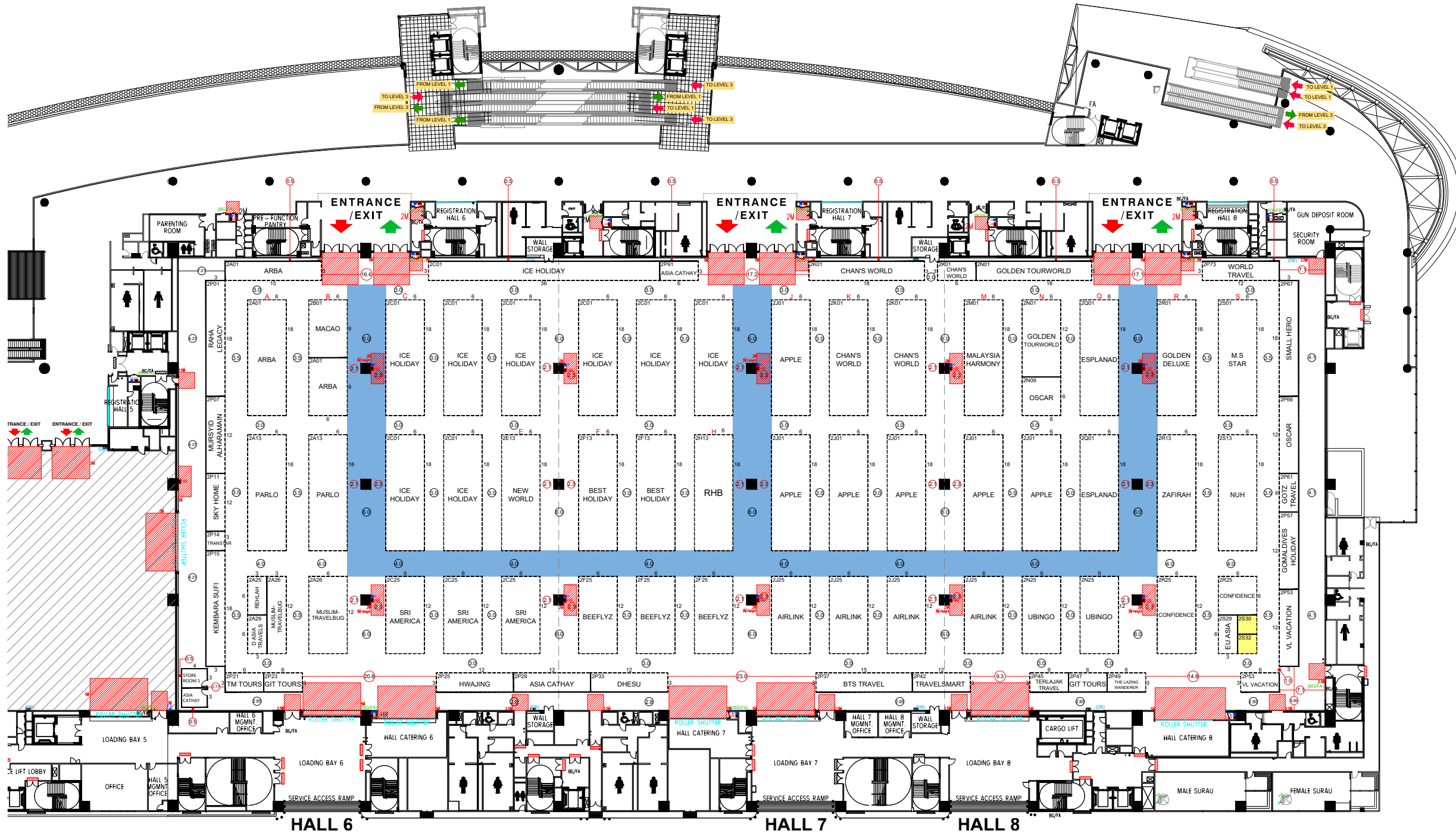

VENUE LEGEND

CODE	DESCRIPTION	CODE	DESCRIPTION
HR	HOSE REEL		NON BUILD AREA
BG/FA	BREAKING GLASS & FIRE ALARM		PILLAR 1650mm x 1650mm
FE	FIRE EXTINGUISHER	HR	FIRE HOSE REEL 600mm x 1000mm
DB	DB BOX		

MAXIMUM LOADING 50k/h
 MAXIMUM CEILING HEIGHT 8m

@ Reserved
 Number Title : SYSF435 - 04

HIGHWAY AREA
 Total of **621** nos. 3m X 3m

** HALL PLAN UPDATE AS 29022024 ARI

Date : 070808
 Revision : 0

MATTA FAIR 2025

HALL 9 - HALL 11, LEVEL 3 (TOP FLOOR)

MALAYSIA INTERNATIONAL TRADE & EXHIBITION CENTRE (MITEC)

18th - 20th APRIL 2025



QUBE Integrated Malaysia Sdn. Bhd.
 A-13-11, MENARA THE MET,
 NO. 20, JALAN DUTAMAS 2,
 50480 KUALA LUMPUR, MALAYSIA
 Tel : +603-6211 9973
 http://www.qube.com.my

JOB NO.
 B017/001/25

PROJECT TITLE
 MATTA FAIR 2025

SHOW PERIOD
 18th - 20th APRIL 2025

VENUE / ADDRESS
 MALAYSIA INTERNATIONAL TRADE & EXHIBITION CENTRE (MITEC)

CITY / COUNTRY
 KUALA LUMPUR, MALAYSIA

CLIENT
 MATTA

CLIENT APPROVAL DATE

DRAWING TITLE SCALE
 HALL 9 - HALL 11 A3 1 : 700
 LAYOUT PLAN A4 1 : 1000

PERSON-IN-CHARGE
 MONG

DRAWN BY DATE
 ARI 27092024

CHECKED BY DATE
 YK 27092024

DRAWING NO.	REVISION
DWG 003	R10 27032025 ARI
	R09 20032025 ARI
	R08 14032025 ARI
	R07 06032025 ARI

REMARKS

OFFICE USED :-
 CHECKLIST

OFFSITE	DESCRIPTION	ON SITE
	Dimension	
	Colour used	
	Material used	
	Graphic used	
	Others	

NOTE (offsite) NOTE (onsite)

CHECKED BY (offsite) CHECKED BY (onsite)

DATE DATE

A COPYRIGHT :-
 This design may not be reproduced in part or whole without prior written permission of Qube Integrated Malaysia Sdn. Bhd. This drawing is subject to modification to suit construction purposes.

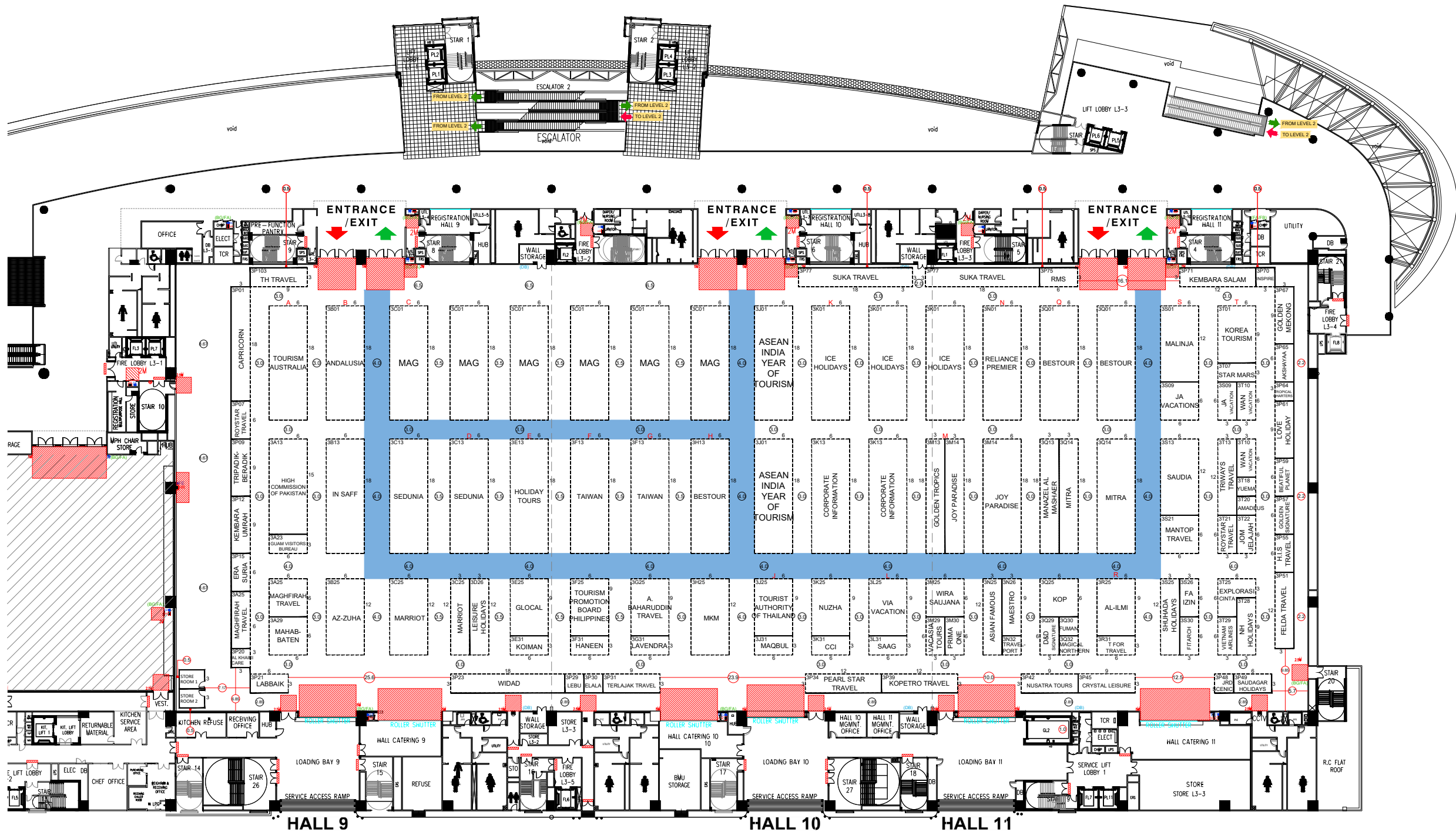

VENUE LEGEND

CODE	DESCRIPTION	CODE	DESCRIPTION
HR	HOSE REEL		NON BUILD AREA
BG/FA	BREAKING GLASS & FIRE ALARM		PILLAR 1650mm x 1650mm
FE	FIRE EXTINGUISHER	HR	FIRE HOSE REEL 600mm x 1000mm
DB	DB BOX		

MAXIMUM LOADING 50k/n
 MAXIMUM CEILING HEIGHT 8m

@ Reserved
 Number Title : SYSF435 - 04

HIGHWAY AREA
 Total of **635** nos. 3m X 3m

** HALL PLAN UPDATE AS 29022024 ARI

Date : 070808
 Revision : 0