

# MATTA FAIR 2024

## HALL 2 - HALL 4, LEVEL 1 (GROUND FLOOR)

### MALAYSIA INTERNATIONAL TRADE & EXHIBITION CENTRE (MITEC)

#### 22nd - 24th MARCH 2024



**QUBE Integrated Malaysia Sdn. Bhd.**  
 Wisma Qube, No 32-3, Jalan Nautika B U20/B, Seksyen U20, TSB Commercial Centre, Sg. Buloh, 40160, Shah Alam, Selangor Darul Ehsan, Malaysia  
 Tel : +603 6151 9973 / 9673 / 9873  
 Fax : +603 6151 3973 / 3673  
 http://www.qube.com.my

JOB NO.  
B 015/001/24

PROJECT TITLE  
MATTA FAIR 2024

SHOW PERIOD  
22nd - 24th MARCH 2024

VENUE / ADDRESS  
MALAYSIA INTERNATIONAL TRADE & EXHIBITION CENTRE (MITEC)

CITY / COUNTRY  
KUALA LUMPUR, MALAYSIA

CLIENT  
MATTA

CLIENT APPROVAL DATE

DRAWING TITLE SCALE  
HALL 2 - HALL 4 A3 1 : 700  
LAYOUT PLAN A4 1 : 1000

PERSON-IN-CHARGE  
MONG

DRAWN BY DATE  
ARI 26102023

CHECKED BY DATE  
YK 26102023

DRAWING NO.	REVISION
DWG 001	R11 29022024 ARI
	R12 08032024 ARI
	R13 15032024 ARI
	R14 18032024 ARI

REMARKS

OFFICE USED :-  
CHECKLIST

OFFSITE	DESCRIPTION	ON SITE
	Dimension	
	Colour used	
	Material used	
	Graphic size	
	Others	

NOTE (offsite) NOTE (onsite)

CHECKED BY (offsite) CHECKED BY (onsite)

DATE DATE

**A COPYRIGHT :-**  
 This design may not be reproduced in part or whole without prior written permission of Qube Integrated Malaysia Sdn. Bhd.  
 This drawing is subject to modification to suit construction purposes.

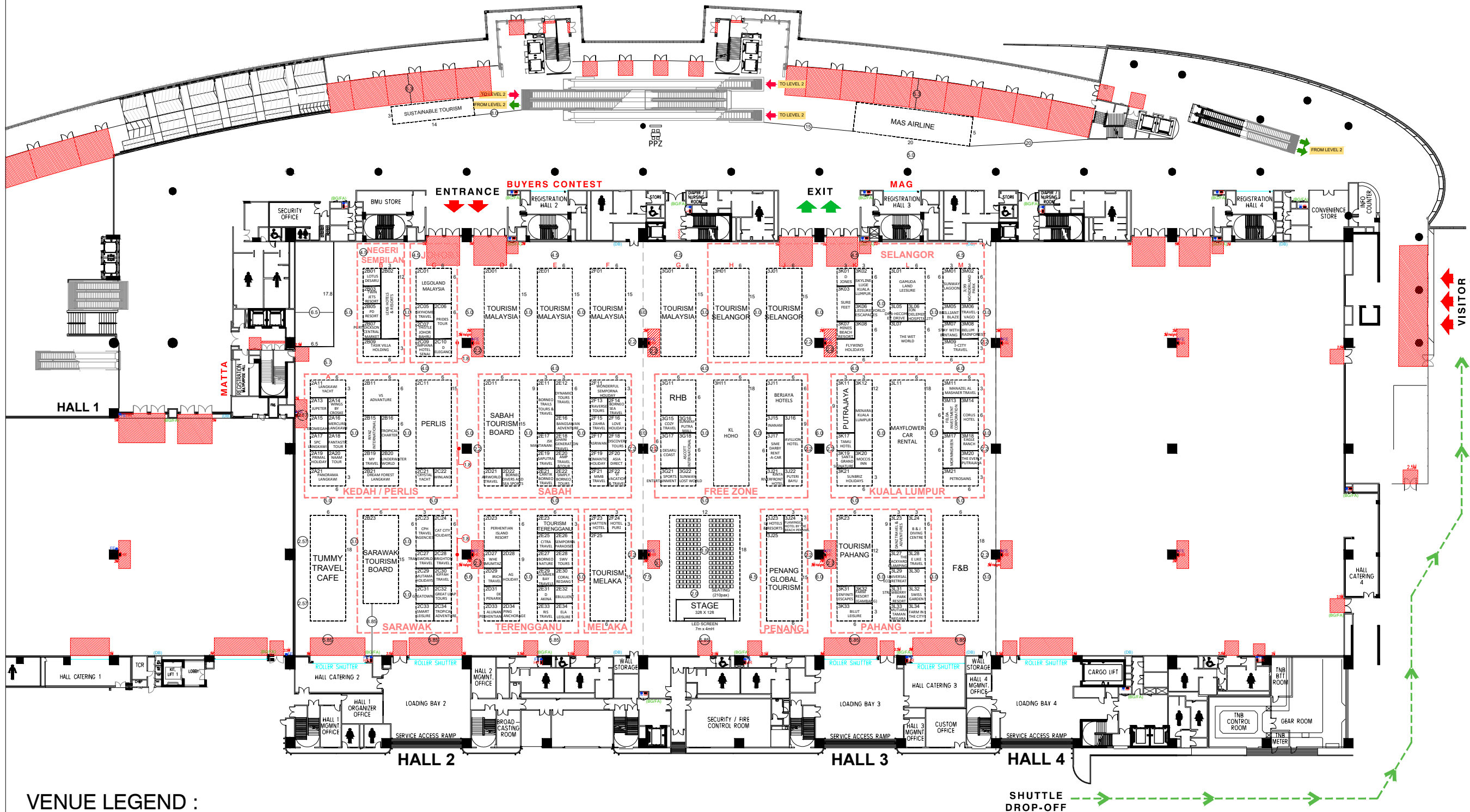

#### VENUE LEGEND :

<b>HR</b>	HOSE REEL		NON BUILD AREA
<b>BG/FA</b>	BREAKING GLASS & FIRE ALARM		PILLAR 1650MM x 1650MM
<b>FE</b>	FIRE EXTINGUISHER		FIRE HOSE REEL 600MM x 1000MM
<b>DB</b>	DB BOX		

MAXIMUM LOADING 50K/N  
 MAXIMUM BOOTH HEIGHT 5M

Total of **348** nos. 3M X 3M

\*\* HALL PLAN UPDATE AS 11022020 AN

# MATTA FAIR 2024

## HALL 6 - HALL 8, LEVEL 2 (MIDDLE FLOOR)

### MALAYSIA INTERNATIONAL TRADE & EXHIBITION CENTRE (MITEC)

#### 22nd - 24th MARCH 2024



**QUBE Integrated Malaysia Sdn. Bhd.**  
 Wisma Qube, No 32-3, Jalan Nautika B U20/B, Seksyen U20, TSB Commercial Centre, Sg. Buloh, 40160, Shah Alam, Selangor Darul Ehsan, Malaysia  
 Tel : +603 6151 9973 / 9673 / 9873  
 Fax : +603 6151 3973 / 3673  
 http://www.qube.com.my

JOB NO.  
B 0 15 / 0 0 1 / 2 4

PROJECT TITLE  
MATTA FAIR 2024

SHOW PERIOD  
22nd - 24th MARCH 2024

VENUE / ADDRESS  
MALAYSIA INTERNATIONAL TRADE & EXHIBITION CENTRE (MITEC)

CITY / COUNTRY  
KUALA LUMPUR, MALAYSIA

CLIENT  
MATTA

CLIENT APPROVAL DATE

DRAWING TITLE SCALE  
 HALL 6 - HALL 8 A3 1 : 700  
 LAYOUT PLAN A4 1 : 1000

PERSON-IN-CHARGE  
MONG

DRAWN BY DATE  
ARI 26102023

CHECKED BY DATE  
YK 26102023

DRAWING NO.	REVISION
DWG 002	R11 29022024 ARI
	R12 08032024 ARI
	R13 15032024 ARI
	R14 18032024 ARI

REMARKS

OFFICE USED :-  
CHECKLIST

OFFSITE	DESCRIPTION	ON SITE
	Dimension	
	Colour used	
	Material used	
	Graphic size	
	Others	

NOTE (offsite) NOTE (onsite)

CHECKED BY (offsite) CHECKED BY (onsite)

DATE DATE

**A COPYRIGHT :-**  
 This design may not be reproduced in part or whole without prior written permission of Qube Integrated Malaysia Sdn. Bhd.  
 This drawing is subject to modification to suit construction purposes.

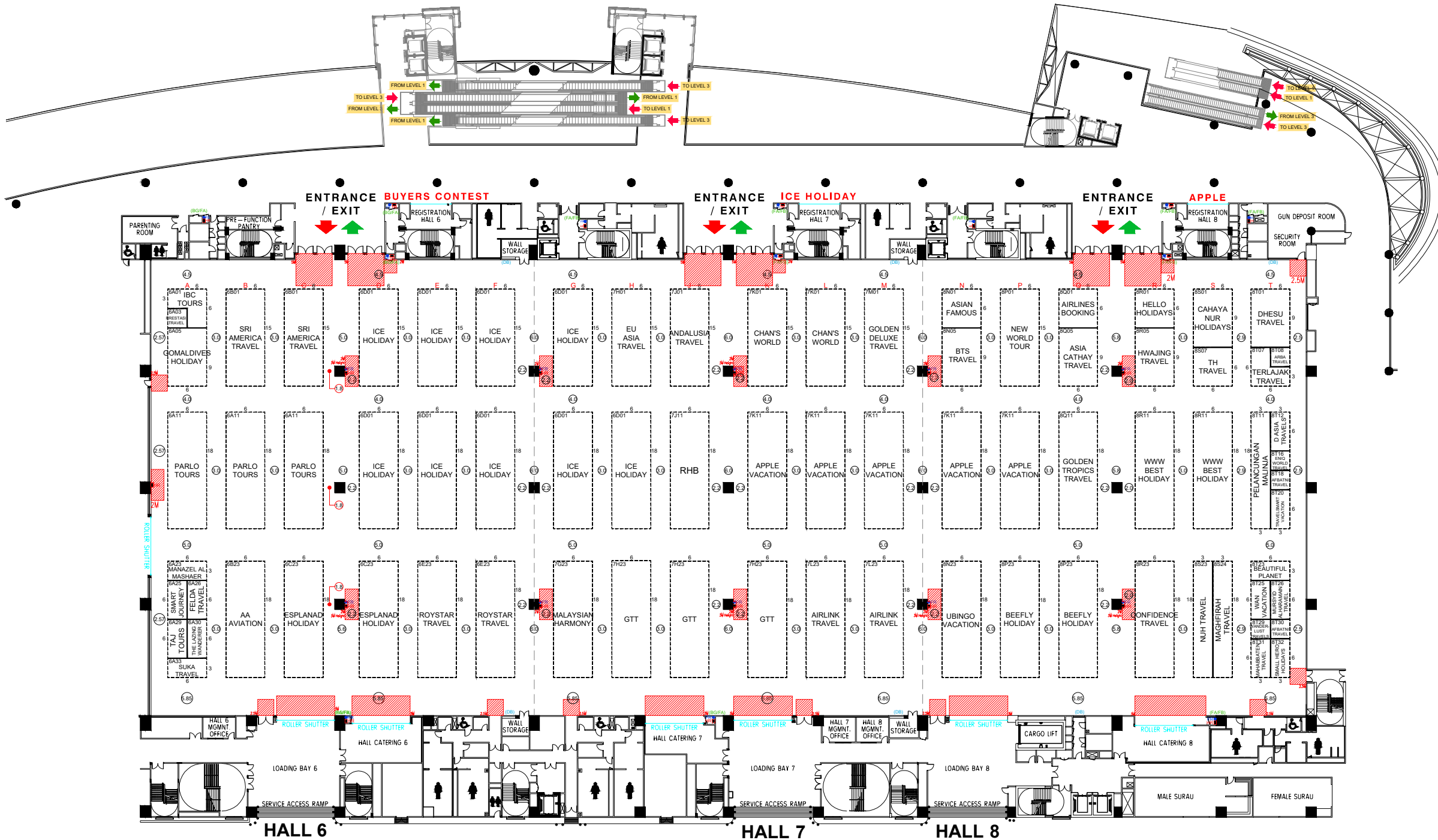

### VENUE LEGEND :

<b>HR</b>	HOSE REEL		NON BUILD AREA
<b>BG/FA</b>	BREAKING GLASS & FIRE ALARM		PILLAR 1650MM x 1650MM
<b>FE</b>	FIRE EXTINGUISHER		FIRE HOSE REEL 600MM x 1000MM
<b>DB</b>	DB BOX		

MAXIMUM LOADING 50K/N  
 MAXIMUM BOOTH HEIGHT 5M

Total of **612** nos. 3M X 3M

\*\* HALL PLAN UPDATE AS 11022020 AN

# MATTA FAIR 2024

## HALL 9 - HALL 11, LEVEL 3 (TOP FLOOR)

### MALAYSIA INTERNATIONAL TRADE & EXHIBITION CENTRE (MITEC)

#### 22nd - 24th MARCH 2024



**QUBE Integrated Malaysia Sdn. Bhd.**  
 Wisma Qube, No 32-3, Jalan Nautika B U20/B, Seksyen U20, TSB Commercial Centre, Sg. Buloh, 40160, Shah Alam, Selangor Darul Ehsan, Malaysia  
 Tel : +603 6151 9973 / 9673 / 9873  
 Fax : +603 6151 3973 / 3673  
 http://www.qube.com.my

JOB NO.  
B 015/001/24

PROJECT TITLE  
MATTA FAIR 2024

SHOW PERIOD  
22nd - 24th MARCH 2024

VENUE / ADDRESS  
MALAYSIA INTERNATIONAL TRADE & EXHIBITION CENTRE (MITEC)

CITY / COUNTRY  
KUALA LUMPUR, MALAYSIA

CLIENT  
MATTA

CLIENT APPROVAL DATE

DRAWING TITLE SCALE  
HALL 9 - HALL 11 A3 1 : 700  
LAYOUT PLAN A4 1 : 1000

PERSON-IN-CHARGE  
MONG

DRAWN BY DATE  
ARI 26102023

CHECKED BY DATE  
YK 26102023

DRAWING NO.	REVISION
DWG 003	R11 29022024 ARI
	R12 08032024 ARI
	R13 15032024 ARI
	R14 18032024 ARI

REMARKS

OFFICE USED :-  
CHECKLIST

OFFSITE	DESCRIPTION	ON SITE
	Dimension	
	Colour used	
	Material used	
	Graphic size	
	Others	

NOTE (offsite) NOTE (onsite)

CHECKED BY (offsite) CHECKED BY (onsite)

DATE DATE

**A COPYRIGHT :-**

This design may not be reproduced in part or whole without prior written permission of Qube Integrated Malaysia Sdn. Bhd. This drawing is subject to modification to suit construction purposes.

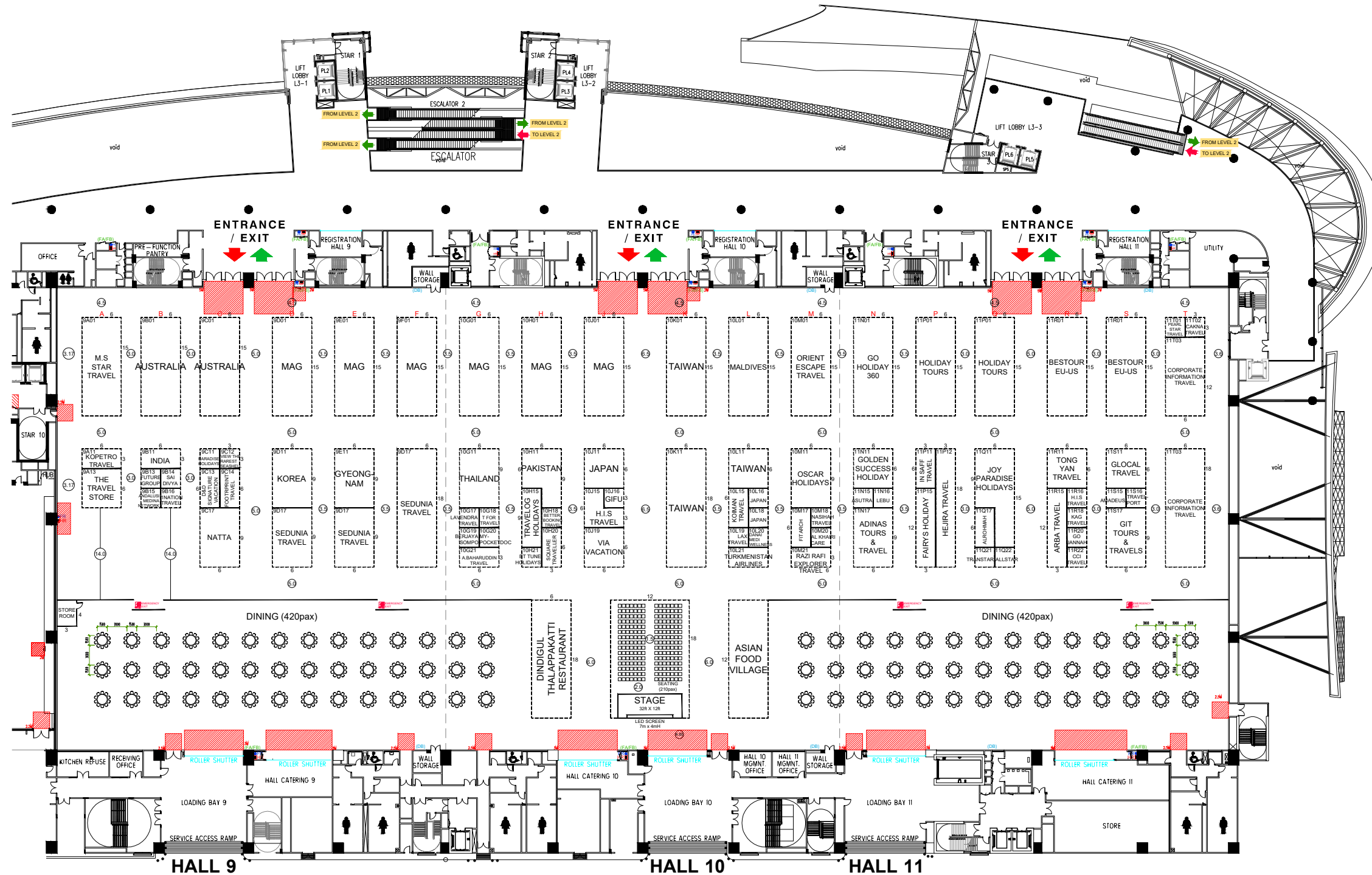

### VENUE LEGEND :

<b>HR</b>	HOSE REEL		NON BUILD AREA
<b>BG/FA</b>	BREAKING GLASS & FIRE ALARM		PILLAR 1650MM x 1650MM
<b>FE</b>	FIRE EXTINGUISHER		FIRE HOSE REEL 600MM x 1000MM
<b>DB</b>	DB BOX		

MAXIMUM LOADING 50K/N  
 MAXIMUM BOOTH HEIGHT 5M

Total of **384** nos. 3M X 3M

\*\* HALL PLAN UPDATE AS 11022020 AN