

MATTA FAIR 2025

HALL 2 - HALL 4, LEVEL 1 (GROUND FLOOR)

MALAYSIA INTERNATIONAL TRADE & EXHIBITION CENTRE (MITEC)

18th - 20th APRIL 2025



QUBE Integrated Malaysia Sdn. Bhd.
 Wisma Qube, No 32-3, Jalan Nautika B U20/B, Seksyen U20, TSB Commercial Centre, Sg. Buloh, 40160, Shah Alam, Selangor Darul Ehsan, Malaysia
 Tel : +603 6151 9973 / 9673 / 9873
 Fax : +603 6151 3973 / 3673
 http://www.qube.com.my

JOB NO.
B 017/001/25

PROJECT TITLE
MATTA FAIR 2025

SHOW PERIOD
18th - 20th NOVEMBER 2025

VENUE / ADDRESS
MALAYSIA INTERNATIONAL TRADE & EXHIBITION CENTRE (MITEC)

CITY / COUNTRY
KUALA LUMPUR, MALAYSIA

CLIENT
MATTA

CLIENT APPROVAL DATE

DRAWING TITLE SCALE
HALL 2 - HALL 4 A3 1 : 700
LAYOUT PLAN A4 1 : 1000

PERSON-IN-CHARGE
MONG

DRAWN BY DATE
ARI 27092024

CHECKED BY DATE
YK 27092024

DRAWING NO.	REVISION
DWG 001a	R01 06122024 ARI
	R02 13122024 ARI
	R03 03012024 ARI

REMARKS

OFFICE USED :-
CHECKLIST

OFFSITE	DESCRIPTION	ON SITE
	Dimension	
	Colour used	
	Material used	
	Graphic used	
	Others	

NOTE (offsite) NOTE (onsite)

CHECKED BY (offsite) CHECKED BY (onsite)

DATE DATE

A COPYRIGHT :-
 This design may not be reproduced in part or whole without prior written permission of Qube Integrated Malaysia Sdn. Bhd.
 This drawing is subject to modification to suit construction purposes.

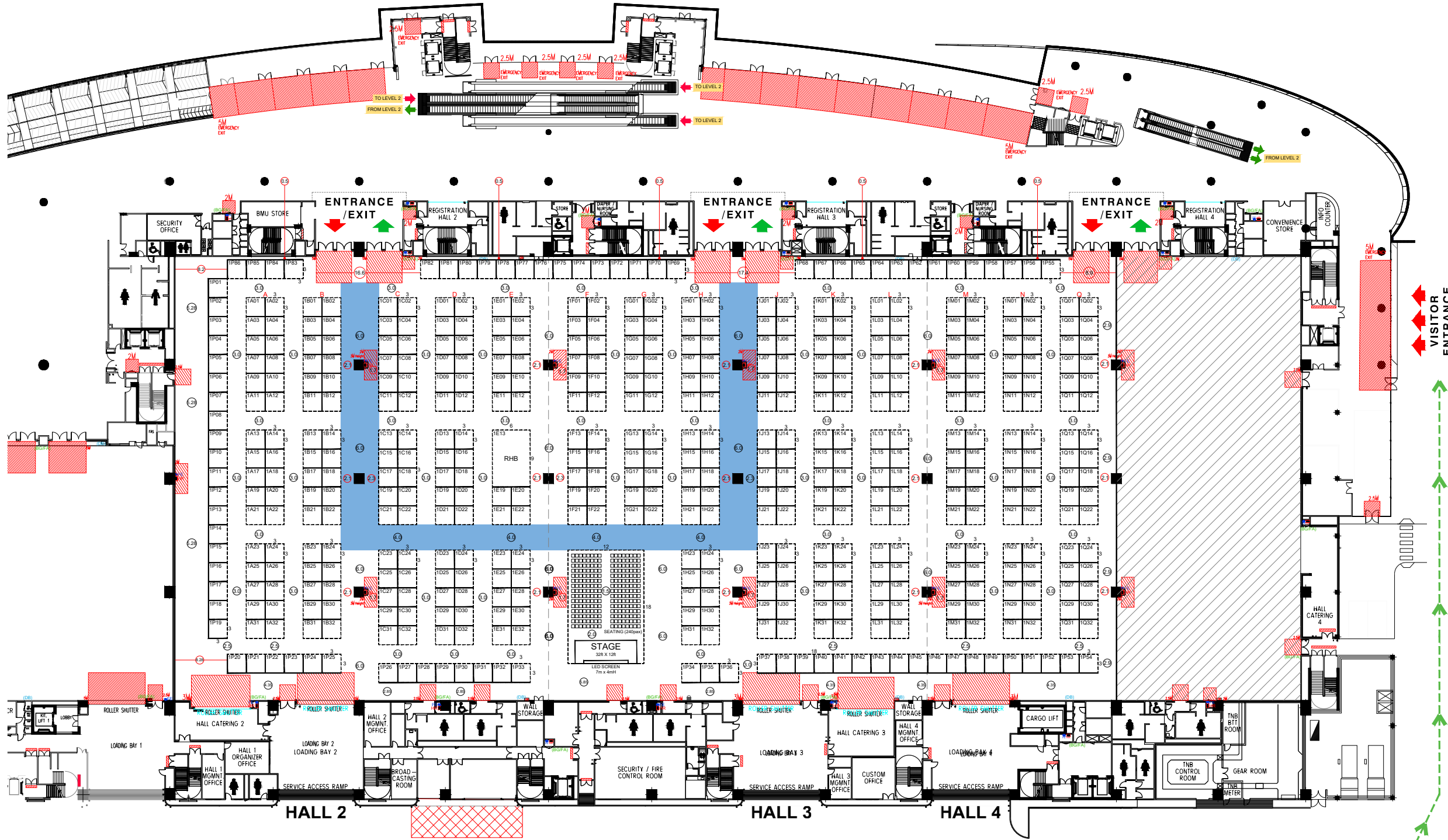

VENUE LEGEND

CODE	DESCRIPTION	CODE	DESCRIPTION
HR	HOSE REEL	[Red Hatched Box]	NON BUILD AREA
BG/FA	BREAKING GLASS & FIRE ALARM	[Black Square]	PILLAR 1650mm x 1650mm
FE	FIRE EXTINGUISHER	[Red Hatched Box]	FIRE HOSE REEL 600mm x 1000mm
DB	DB BOX	[Red Hatched Box]	

MAXIMUM LOADING 50k/h
 MAXIMUM CEILING HEIGHT 8m

@ Reserved
 Number Title : SYSF435 - 04

HIGHWAY AREA
 Total of **514** nos. 3m X 3m

** HALL PLAN UPDATE AS 29022024 ARI

Date : 070808
 Revision : 0

MATTA FAIR 2025

HALL 6 - HALL 8, LEVEL 2 (MIDDLE FLOOR)

MALAYSIA INTERNATIONAL TRADE & EXHIBITION CENTRE (MITEC)

18th - 20th APRIL 2025



QUBE Integrated Malaysia Sdn. Bhd.
 Wisma Qube, No 32-3, Jalan Nautika B U20/B, Seksyen U20, TSB Commercial Centre, Sg. Buloh, 40160, Shah Alam, Selangor Darul Ehsan, Malaysia
 Tel : +603 6151 9973 / 9673 / 9873
 Fax : +603 6151 3973 / 3673
 http://www.qube.com.my

JOB NO.
B 017/001/25

PROJECT TITLE
MATTA FAIR 2025

SHOW PERIOD
18th - 20th NOVEMBER 2025

VENUE / ADDRESS
MALAYSIA INTERNATIONAL TRADE & EXHIBITION CENTRE (MITEC)

CITY / COUNTRY
KUALA LUMPUR, MALAYSIA

CLIENT
MATTA

CLIENT APPROVAL DATE

DRAWING TITLE SCALE
 HALL 6 - HALL 8 A3 1 : 700
 LAYOUT PLAN A4 1 : 1000

PERSON-IN-CHARGE
MONG

DRAWN BY DATE
ARI 27092024

CHECKED BY DATE
YK 27092024

DRAWING NO.	REVISION	
	DWG 002	R01
	R02	13122024 ARI
	R03	03012024 ARI

REMARKS

OFFICE USED :-
CHECKLIST

OFFSITE	DESCRIPTION	ON SITE
	Dimension	
	Colour used	
	Material used	
	Graphic size	
	Others	

NOTE (offsite) NOTE (onsite)

CHECKED BY (offsite) CHECKED BY (onsite)

DATE DATE

A COPYRIGHT :-
 This design may not be reproduced in part or whole without prior written permission of Qube Integrated Malaysia Sdn. Bhd.
 This drawing is subject to modification to suit construction purposes.



VENUE LEGEND

CODE	DESCRIPTION	CODE	DESCRIPTION
HR	HOSE REEL		NON BUILD AREA
BG/FA	BREAKING GLASS & FIRE ALARM		PILLAR 1650mm x 1650mm
FE	FIRE EXTINGUISHER	HR	FIRE HOSE REEL 600mm x 1000mm
DB	DB BOX		

MAXIMUM LOADING 50k/h
 MAXIMUM CEILING HEIGHT 8m

@ Reserved
 Number Title : SYSF435 - 04

HIGHWAY AREA
 PREMIUM BOOTH
Total of 621 nos. 3m X 3m

** HALL PLAN UPDATE AS 29022024 ARI

Date : 070808
 Revision : 0

MATTA FAIR 2025

HALL 9 - HALL 11, LEVEL 3 (TOP FLOOR)

MALAYSIA INTERNATIONAL TRADE & EXHIBITION CENTRE (MITEC)

18th - 20th APRIL 2025



QUBE Integrated Malaysia Sdn. Bhd.
 Wisma Qube, No 32-3, Jalan Nautika B U20/B, Seksyen U20, TSB Commercial Centre, Sg. Buloh, 40160, Shah Alam, Selangor Darul Ehsan, Malaysia
 Tel : +603 6151 9973 / 9673 / 9873
 Fax : +603 6151 3973 / 3673
 http://www.qube.com.my

JOB NO.
B 0 1 7 / 0 0 1 / 2 5

PROJECT TITLE
MATTA FAIR 2025

SHOW PERIOD
18th - 20th NOVEMBER 2025

VENUE / ADDRESS
MALAYSIA INTERNATIONAL TRADE & EXHIBITION CENTRE (MITEC)

CITY / COUNTRY
KUALA LUMPUR, MALAYSIA

CLIENT
MATTA

CLIENT APPROVAL DATE

DRAWING TITLE SCALE
 HALL 9 - HALL 11 A3 1 : 700
 LAYOUT PLAN A4 1 : 1000

PERSON-IN-CHARGE
MONG

DRAWN BY DATE
ARI 27092024

CHECKED BY DATE
YK 27092024

DRAWING NO.	REVISION
DWG 003	R01 06122024 ARI
	R02 13122024 ARI
	R03 03012024 ARI

REMARKS

OFFICE USED :-
CHECKLIST

OFFSITE	DESCRIPTION	ON SITE
	Dimension	
	Colour used	
	Material used	
	Graphic used	
	Others	

NOTE (offsite) NOTE (onsite)

CHECKED BY (offsite) CHECKED BY (onsite)

DATE DATE

A COPYRIGHT :-
 This design may not be reproduced in part or whole without prior written permission of Qube Integrated Malaysia Sdn. Bhd.
 This drawing is subject to modification to suit construction purposes.



VENUE LEGEND

CODE	DESCRIPTION	CODE	DESCRIPTION
HR	HOSE REEL		NON BUILD AREA
BG/FA	BREAKING GLASS & FIRE ALARM		PILLAR 1650mm x 1650mm
FE	FIRE EXTINGUISHER	HR	FIRE HOSE REEL 600mm x 1000mm
DB	DB BOX		

MAXIMUM LOADING 50k/h
 MAXIMUM CEILING HEIGHT 8m

@ Reserved
 Number Title : SYSF435 - 04

HIGHWAY AREA
 Total of **635** nos. 3m X 3m

** HALL PLAN UPDATE AS 29022024 ARI

Date : 070808
 Revision : 0